

FAG

**20205-TVP**

Barrel roller bearing

Schaeffler ID:  
0167017390000Barrel roller bearings 202, main  
dimensions to DIN 635-1

## Technical information

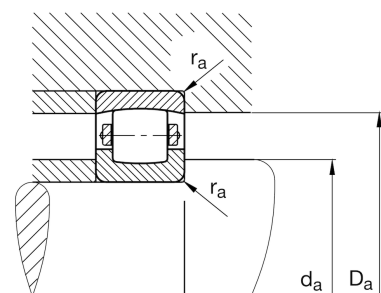
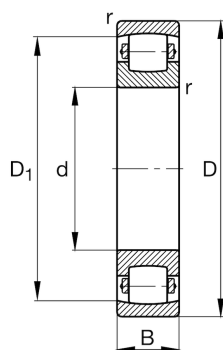
**Main Dimensions & Performance Data**

d	25 mm	Bore diameter
D	52 mm	Outside diameter
B	15 mm	Width
C <sub>r</sub>	24,100 N	Basic dynamic load rating, radial
C <sub>0r</sub>	24,900 N	Basic static load rating, radial
C <sub>ur</sub>	2,260 N	Fatigue load limit, radial
n <sub>G</sub>	11,500 1/min	Limiting speed
	0.135 kg	Weight

**Dimensions**

r <sub>min</sub>	1 mm	Minimum chamfer dimension
D <sub>1</sub>	43.9 mm	Bore diameter outer ring

**Mounting dimensions**

d <sub>a min</sub>	30.6 mm	Minimum diameter shaft shoulder
D <sub>a max</sub>	46.4 mm	Maximum diameter of housing shoulder
r <sub>a max</sub>	1 mm	Maximum recess radius

**Temperature range**

T <sub>min</sub>	-30 °C	Operating temperature min.
T <sub>max</sub>	120 °C	Operating temperature max.